

Vibration-proof bridge inspections

BGL SERIES



SEBP-BGL



SEBP-BGL-P

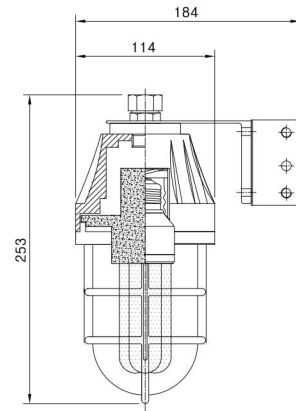

Technical Data

Catalog No.	Watt	Lamp
SEBP-BGL	Max.EL25W	E26
SEBP-BGL-P	Max.EL25W	E26



Application

- Girder type (Steel Box, PC Box) bridge as an internal check.
- Truss-type (lightweight construction) lower bridge inspections.
- Cable-stayed bridge, suspension bridge pylon internal inspections.
- IC, JCT, including internal inspection interval structures.



Features

- Apply clamps : horizontal mounting and vertical mounting.
- Apply bracket : wall mounting, wall anchor mounting.
- Vibration frequency : 30Hz, Amplitude : 3mmpp, Axis : up and down Vibration
- Time : 1Hour, The test result is good.



Standard Materials

- Body : Die Casting Aluminium
- Cover : Die Casting Aluminium
- Bracket : Steel.
- Socket : Porcelain with Mogul Socket E39
- Bracket :Steel
- Clamp : Steel
- Glass : Heat Resistant Hard Glass



Standard Finish

- MUNSELL No. White N-9.3
- If you want another color, contact us please.